



### Seqwater

Seqwater is the Queensland Government Bulk Water Supply Authority. They are responsible for providing a safe, reliable and affordable bulk drinking water supply for 3.2 million people across South East Queensland.

Seqwater Operations extend from Gympie to the New South Wales border, and west to the base of the Toowoomba ranges. This makes Seqwater one of Australia's largest water businesses with the most geographically spread and diverse asset base of any capital city water authority.

### Compelling need for the project

The existing step ladder system did not meet Australian standards, and the existing fall arrest system is difficult and unsafe to use.

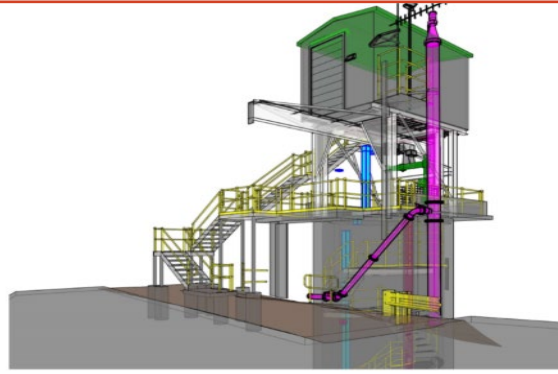

### Replace access system into raw water dry well pump station Lowood, Queensland

#### Business value created for the client

Wiley were commissioned to complete a laser scan of the pump station, including the internal elements which were located in a confined space.

State of the art technology was used, allowing all internals to be scanned, without the need for personnel to enter. The point cloud data was entered into a Revit model, which enabled the Design Engineer to obtain key dimensional data.

Wiley worked closely with Seqwater's key stakeholders, which sought maximum involvement in all stages of the project.

#### The challenging scope Wiley delivered

Wiley were engaged to design a new access system that allowed for Seqwater to enter Lowood pump station safely. Key project points:

- The pump station was classified as a confined space
- The existing infrastructure was installed over 30 years prior
- Wiley completed a condition assessment of the existing access system into the Lowood pump station
- The assessment cross-checked the existing infrastructure for compliance against current Australian standards
- Wiley completed a detailed design of the new access system, which provided safe access to the plant and equipment for operation and maintenance activities.
- The new design eliminated fall from height risk
- The designed access to the raw water dry well is compliant with AS 1657, the Australian Building Code, and all other applicable standards and legislation.
- Consultation with Seqwater stakeholders to achieve a suitable design.
- The design was managed to ensure it was delivered to Seqwater's schedule.